



Cricklewood Farm Aerial (1960)

- **Over 540 Pages**
- **240 Historical Photos**
- **Several Historical Vignettes**
- **118 Recent Photos of Historical Structures and Sites**
- **136 Annotated Topo Maps**
- **51 Genealogy Snapshots**
- **110 GPS Farm Waypoints**
- **Land Ownership Details**
- **What's There Now?**
- **Remembrances from Many Who:**

“Were There When It Happened!”



This book presents a considerable history of the farm families and farms of Carmel, Indiana—as it has been preserved in memory, cherished heirlooms, carefully safeguarded photos, and historical maps. Shown here are content examples.

“The Captain Lewis Dean Causey’s adopted nine children including 3 sets of twins including Dave and Dean. Dave and Dean both drove sports cars in the SCCA Sports Car Club of America. Dave and Dean built an old Sherman tank with a VW engine in it that I got to drive to school one day. That field where the south end of Vickery Lane is now was where we used to fly the gyrocopter that Dave and Dean built. They used the Sherman tank to get it up in the air.” (Nena Park Ray, 2013)

Charles Warren Fairbanks

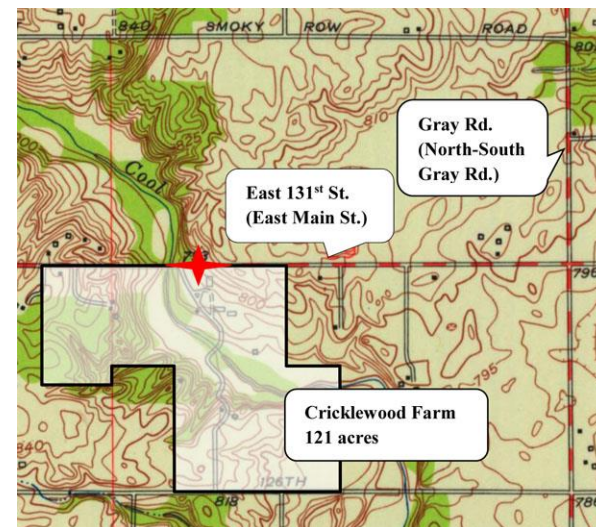
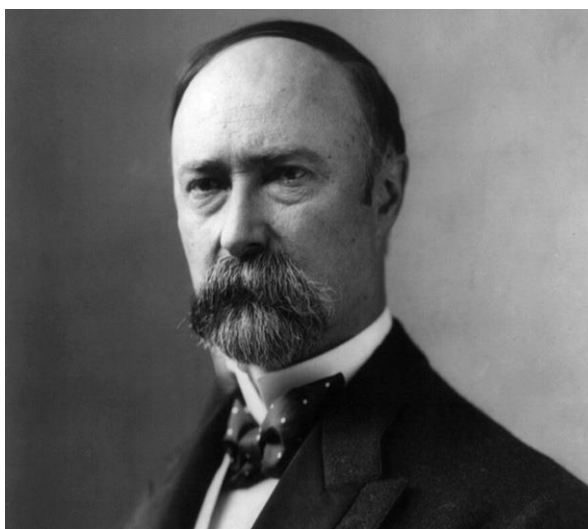

Annotated 1952 Topo Map of Cricklewood Farm

Genealogy Snapshot:

Charles Warren Fairbanks, b. 1852, Union, OH (m. Cornelia Cole)

Children:

- **Mary Adelaide Fairbanks (1875-1961) (m. (1929) Capt. Lewis Dean Causey)**
- **Warren Charles Fairbanks (1878-1938)**
- **Frederick Cole Fairbanks (1881-1940)**
- **Richard Monroe Fairbanks, Sr. (1883-1944)**
- **Robert C. Fairbanks (1888-1951)**

Charles Warren Fairbanks was Vice President of the United States under Theodore Roosevelt. His daughter, Mary Adelaide Fairbanks, bought Cricklewood Farm from Woods Caperton after 1933.

Order Form:

To order one or more copies of this book,
please fill out this form (please print):

Name:

Street Address:

City, State, & Postal Code:

Country:

Phone:

E-mail Address:

The cost of this book per copy is:

Grayscale (B&W): \$89.99 plus \$9.99 (S&H) =
\$99.98

Color: \$139.99 plus \$9.99 (S&H) = **\$149.98**

Please pay by check, allow up to 4 weeks for
printing and delivery, and send with this form to:

John Graves

**612 Lavender Court
West River, MD 20778**

Questions? Need more information? Please
email the author at: johntmti@aol.com.



“Cool Creek at Cricklewood Farm (2017):” Photo taken by Jennifer
Hershberger and reproduced here by special permission.
“Cricklewood Farm Aerial:” Photo provided by Doug Callahan.

Farm Profiles

Acorn Farm	Hope Crest Farm
ABS Farm	Huber-Fertig Farm
Applegate Farm	Hunt Family Farm
Bassett Farm	Hussey Farm
Bellport Farm	IHP Farm
Block Farm	Jessup Farm
Blue Farm	Johnson Farm
Booth Farm	Katterhenry Farm
Bowen Farm	King Farm
Bower Farm	Kinzer Family Farm
Bracken Farm	Kirk Farm
Brooks Farm	Kitchens Farm
Brunson Farm	Klingensmith Family Farm
Carey Farm	Lamb Farm
Clark Farm	Lynnwood Farm
Compton Farm	Massey Farm
Conner Prairie Farm	Mayo Farm
Cool Creek Farm	Meek Farm
Cotton Farm	Mitchel Farm
Cox Farm	Moffitt Family Farm
Craven Farm	Mueller Farm
Cricklewood Farm	Myers Family Farm
Cy-Er Farm	Newby Family Farm
Daubenspeck Farm	Oak Hill Farm
Dawson Family Farm	Powell Family Farm
Day Farm	Pursel Family Farm
Dinkelaker Farm	Puttertime Farm
Dunn Farm	Randall Family Farm
Efroymsen Farm	Riley Brothers Farm
Eichard Farm	Riner Farm
Ellis Farm	Robinson Farm
Fairchild Farm	Roeder Farm
Featherston Farm	Rogers Farm
Fish Farm	Rohrer Farm
Flaskamp Farm	Rolling Ridge Farm
Fortune Farm	Schwegman-Henley Farm
Foster Family Farm	Schwitzerland Farm
Foster-Kendall Farm	Senator Farm
Garner Farm	Settle Farm
Graves Family Farm	Sheets Farm
Gregg Farm	Shelburn Farm
Hampton Farm	Shoemaker-Collins Farm
Happy T Farm	Simpson Farm
Harr Farm	Smith Farm
Harvey Family Farm	Starn Farm
Haston Farm	Stokely-Van Camp Farm
Heather Farm	Stuckey Farm
Hendren Farm	Symons Family Farm
Hensel Family Farm	Timberlane Farm
Hiller Farm	Two Gaits Farm
Hinshaw Farm	Warner Farm
Hobby Horse Farm	Watts Farm
Holly Lane Farm	Weidlich-Ottinger Farm
Hoover Farm	Weikal Farm
	White Haven Farm
	White Oak Farm
	Williamson Family Farm
	Wind Pump 80 Farm

Eight and a Half Years:

Honorable Work for the Benefit of Us All: Remembering the Farm Families and Farms of Carmel, Indiana



Cool Creek at Cricklewood Farm (2017)

The Book!

